

THE SCARLETTE HOME

3 bed | 2 bath | 2 car
SPRING CREEK, NV - by Bailey Homes

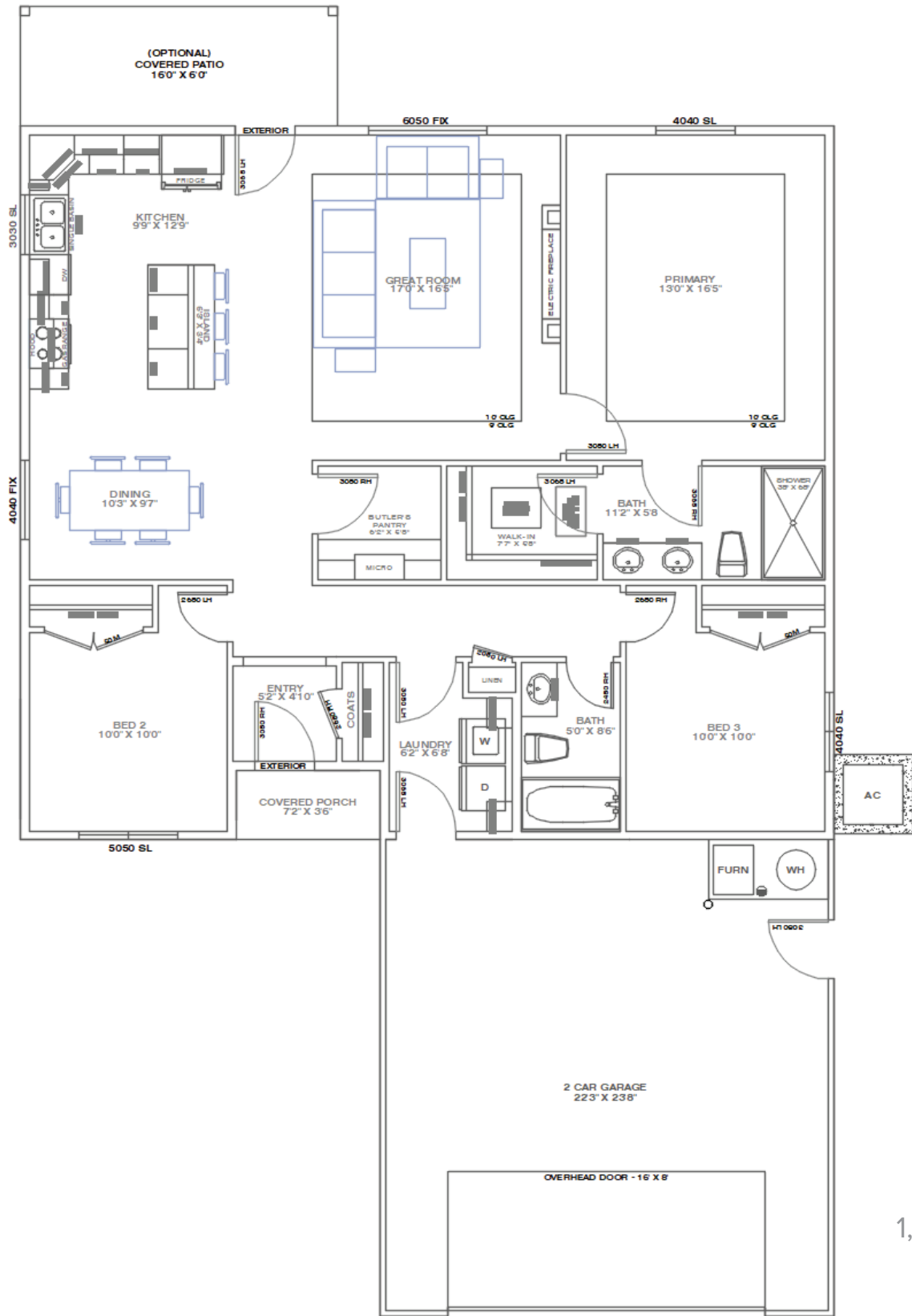

TOTAL
1,451 SF

STANDARD FEATURES

SPRING CREEK, NV - by Bailey Homes

4 bedroom luxury living

A spacious 4 bedroom executive home at Cambridge Estates in Elko, NV. Designed for open living and entertaining space. Enjoy a large kitchen with a massive 7' long island, walk-in pantry, and open to the dining and great room. A luxury master suite with an oversized walk-in closet, jetted tub and extra large executive walk-in shower. Expect all the same luxury standards included with every Bailey home.

EXTERIOR

- Vinyl siding with stone accents
- 30 year architectural shingles
- Rain gutters & downspouts
- Covered front porch

GREAT ROOM

- Large open design, perfect for entertaining
- Luxury Vinyl Plank flooring
- Ceiling fan & recessed lighting
- 10' ceiling tray

MASTER SUITE

- Walk-in closet
- Ceiling fan & recessed lighting
- Walk-in shower with tile walls & floor
- Vanity cabinet with dovetail drawers
- Soft close doors
- Soft close drawers
- Granite countertops

BATHROOMS

- Vanity cabinet with dovetail drawers & soft close
- Soft close drawers
- Granite countertops
- Tile or LVP floors
- Moen faucets

KITCHEN & DINING

- Articulated cabinets with crown moulding
- Staggered heights and depths
- Soft close drawers
- Soft close doors
- Granite countertops with full tile backsplash
- Large kitchen bar
- Energy Star stainless steel appliances
- Luxury Vinyl Plank flooring
- Moen faucets

ENERGY EFFICIENT DESIGN

- Heavy duty insulation
- 1" thick insulated LOW-E glass windows
- Insulated crawl-space foundation or basement

GARAGE

- Extra large 2 or 3 car garage
- Sheetrocked & Insulated
- Garage door openers with digital keyless security pad

OTHER

- Central air conditioning
- Natural Gas Furnace
- Electric Fireplace

